

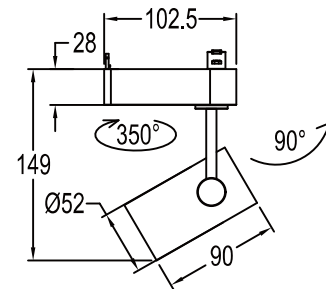

FEATURES

- Single phase LED track light
- Aluminum body
- Powder coated finish
- Constant current LED driver fitted
- 350° rotatable 90° adjustable head
- Color rendering index 90
- Colour option: White & Black
- Ta: -20°C to +40°C
- Suitable for Residential and Commercial Area



TECHNICAL SPECS

Item No.	Power	Lumen Output	CRI	Colour Temp	Beam Angle	Colour	Dimmable
R020-1L	6	340lm	>90Ra	3000K	24°	Black or White	Non-dim
10032P3KBK	20	1750lm	>90Ra	3000K	38°	Black	Non-dim
10032P3KW H	20	1750lm	>90Ra	3000K	38°	White	Non-dim